

KEY

- Worship/Welcome
- Wheelchair accessible WC & baby changing
- Choir Vestry/Small Meeting Room
- Kitchen Servery
- New or altered circulation space
- Storage
- Quiet Prayer
- Clergy Vestry
- Chancel/Sanctuary
- Pulpit
- Children's Area

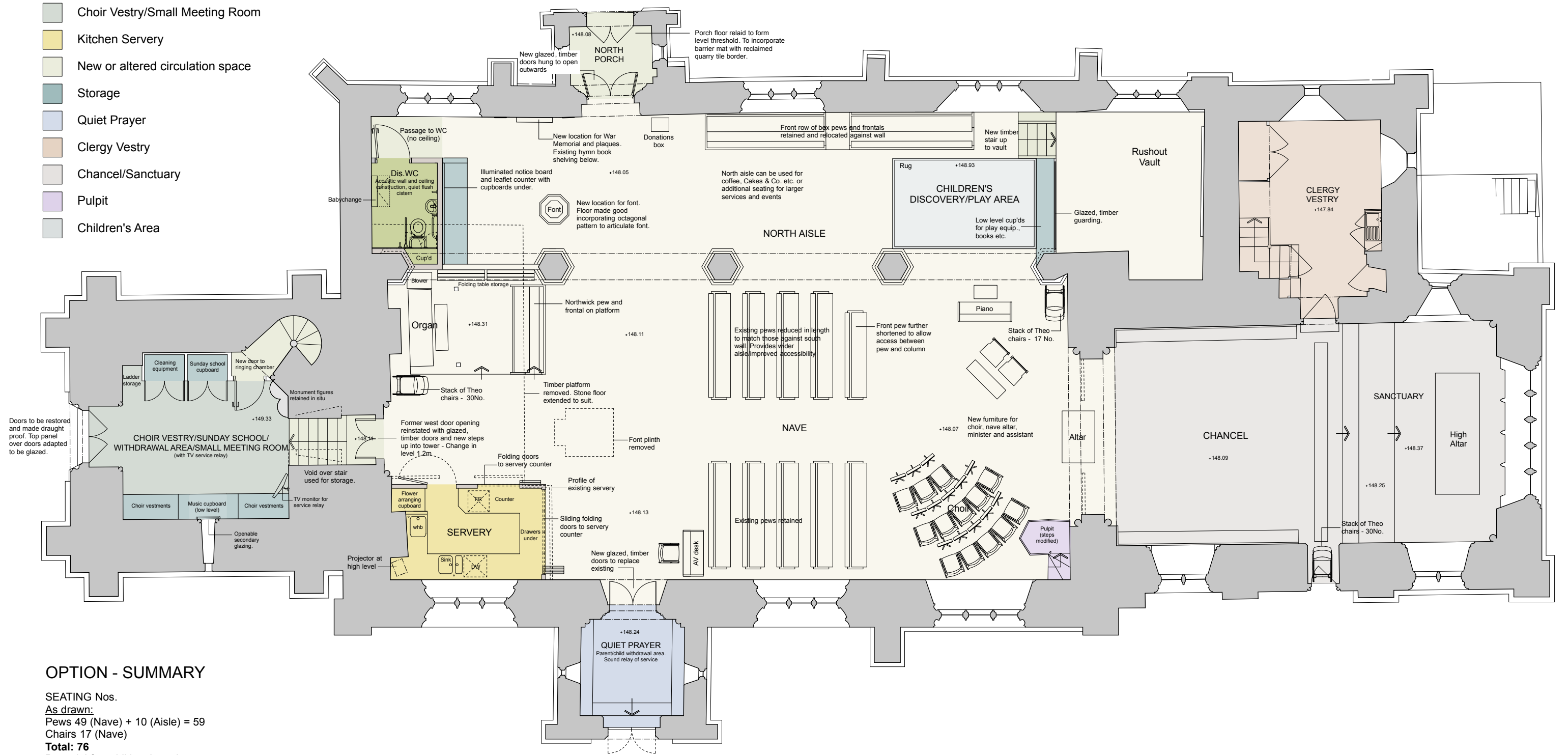

OPTION - SUMMARY

SEATING Nos.
As drawn:
 Pews 49 (Nave) + 10 (Aisle) = 59
 Chairs 17 (Nave)
Total: 76
Potential for additional seating:
 Theo Chairs: 77
Max Total Seating : 153

WEST TOWER

Infilled doorway from Nave opened up and gothic arch repaired.
 Rear norman arch repaired.
 Passage through Tower wall widened to suit width of reinstated door opening.
 Stair installed within passage to manage change in level.
 West Tower reordered to create Choir Vestry/SundaySchool/Withdrawal Area/Meeting Room and Storage.

NORTH AISLE

West end of North Aisle reordered to provide fully accessible WC with baby changing provision, information counter and illuminated notice board.
 War memorial relocated to north wall.
 All fixed pews removed from North Aisle with the exception of front pews and frontals which are to be relocated against north wall.

NAVE - West End

Area between Rushout Vault and north entrance to be used for Children's Play Area and flexible seating/tables.
 Internal entrance doors to North Porch replaced with glazed and timber framed doors, hung to open outwards.
 Porch floor lowered to create level access.

NAVE - East End

Timber pew platform at west end removed and replaced with new stone floor level with rest of Nave.
 Organ platform extended to accommodate relocated Northwick pew and frontal.
 New servery, flower arranging and storage to replace existing kitchenette/vestr.
 Font repositioned to north aisle.

SOUTH PORCH

Access to Pulpit modified. North bank of pews shortened to provide wider center aisle.
 Additional seating provided by stacking chairs when required.
 Fixed choir stalls replaced with chairs and music stands.
 Choir located on south side of nave.

GENERAL

To be restored for use as an area for quiet prayer. To be accessed from Nave via new glazed and timber framed doors. Doors draught proofed. New lighting installed.

New heating system throughout.
 Lighting system extended and improved.
 Sound system to be upgraded.

CLIENT	Incumbent & Church Wardens
PROJECT	Reordering St. Peter & St. Paul's Church, Blockley
TITLE	Option 9
Proposed Plan	
SCALE	1:100@A3, 1:50@A1
DATE	May 2022
JOB N°	19-025
DRAWN	DS
DRAWING N°	010

Acanthus Clews architects
 Acanthus House
 57 Hightown Road
 Banbury • Oxfordshire
 OX16 9BE
 Tel: 01295 702600
 Fax: 01295 702601
 architects@acanthusclews.co.uk
 www.acanthusclews.co.uk